

## APPLICATION

For the use of accent lighting. To install as recessed mounted. Perfect for applications desiring a dynamic color changing effect. Recommended for retail, modern residential, hospitality and entertainment installations. RGBW design allows fine-tuned pastel colors and saturated hues without sacrificing illumination brightness. Belongs to C70 series family.

## ELECTRICAL

### Power Input:

Direct 120V-240V AC input comes standard. Available with 24DC or 120V-277V options. 0.15A Max. See ordering guide below.

### Power Input Connection:

Direct Line Voltage hard-wired inside electrical junction box. Standard knock-out conduit entries with multiple sizes for through wiring.

### Power Consumption:

0.1-10W.  
[Stand-by wattage not included].

## PHYSICAL

### Environment:

IC rated for direct contact with loose insulation.

### Construction:

Made of heavy gauge cold-rolled steel to protect light emitting diodes, other electronics and preserve optical alignment. Integral junction box provides easy access for electrical maintenance, via remodeling clips. Die-Cast construction trim ring flange covers ceiling opening. Steel Blades/Springs installed on trim for a tight gap-free installation onto housings. Recommended for ceiling thickness up to 0.75".

### Housing Finish:

Painted black to eliminate stray light leaks.

### L70 Life:

35,000 Hours for ambient temperatures under 85°F.

### Temperature Rating:

0°F - 120°F Ambient.

### Pendant:

Fully frosted glass pendant with machined aluminum heat sink. Comes with 48" field-adjustable extension cable.

## COLOR DETAILS

### DirectDMX Color Control:

Color controlled with USITT DMX512A Standard Protocol to work with Coloronix or 3rd Party DMX Systems such as the Color Kinetics® iPlayer 3. On board Dip Switches inside the Data Enabler allow selecting of DMX addresses between 1-512 in a given DMX universe. DMX Data fed to housing via standard RJ45 connectors. Data Input/Output ports allow daisy-chaining of DMX Signal.

### LED Die Colors:

Red [620-635nm] Blue [450-465nm]  
Green [520-535nm] Neutral White [4000k]

### Static Color Available:

All Std. Colors, Consult Factory.

### Stand Alone Color Control:

Pre-Programmed static and dynamic scenes, as well as specific colors, can be user activated by the integral Data Enabler's computer eliminating the need for an external data source. On board Dip Switches inside the Data Enabler allow selecting of over 30 static and dynamic color sequences. Color and Scenes can be selected with a remote control [SCC5-RM] using an infrared ColorRay receiver [SCC5-IR].

### Color Mixing:

Using InternaMix™ proprietary technology, colors are efficiently blended together through an internal mixing chamber. The one-color output reduces unsightly views of isolated Red, Green and Blue Diodes for a seamless rainbow-free appearance.

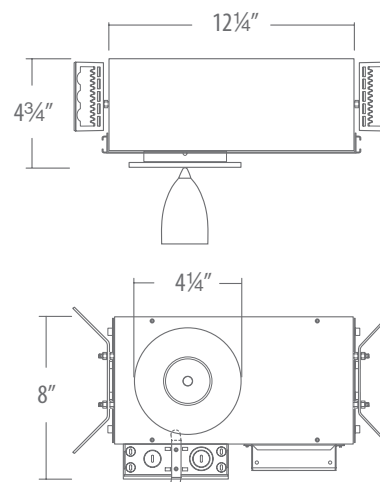

Ceiling Opening : 3 7/8"

### Dimming:

Smooth and flicker-free dimming of all colors down to 1% using Patented Color Mixing and Dimming technologies developed at Philips Color Kinetics®

## COMPATIBILITY

### Accessories:

**SWR2RJ45-BK-72:** 72" RJ45 Extension  
**PCL002:** RJ45 DMX Terminator

**PCL003:** DMX RJ45/Terminal Block Coupler  
**PCL004:** RJ45 Coupler

## SAFETY

ETL Listed Complies to UL1598 and ANSI/UL 8750.  
Damp Location Rated.  
IP52 Protection.

## ORDERING

▶ example: **SH3LDC70RGBWV024/SRP400**

HOUSING	POWER INPUT	FINISH
<b>SH3LDC70RGBW</b>	<b>Blank :</b> 120V-240V AC <b>V024 :</b> 24V DC <b>V277 :</b> 120V-277V AC	<b>/SRP400 :</b> White



Licensed by:  
**PHILIPS**  
sense and simplicity