

## APPLICATION

For the use of direct flood and/or accent lighting. To install as an above grade fixture. Perfect for applications desiring a dynamic color changing effect. Recommended for retail, modern residential, hospitality and entertainment installations. RGBW design allows fine-tuned pastel colors, saturated hues without sacrificing illumination brightness. DMX control option allows the use of DMX512 Control Systems to individually control and change colors, set looks,

and add lighting effects which can affect moods, feelings and atmosphere.

- 15W 481 Max. Lumen
- DMX direct via data enabler
- Multiple beam spreads
- LED Die Colors: RGBW
- Static Colors Available
- Wet location IP67

- Using InternaMix™ proprietary technology, colors are efficiently blended together through an internal mixing chamber. The one-color output reduces unsightly views of isolated rainbow like striations.
- Smooth and flicker-free dimming of all colors down to 1% using patented color mixing and dimming technologies developed at Philips Color Kinetics®
- 3 Year Warranty

## DIMENSIONS

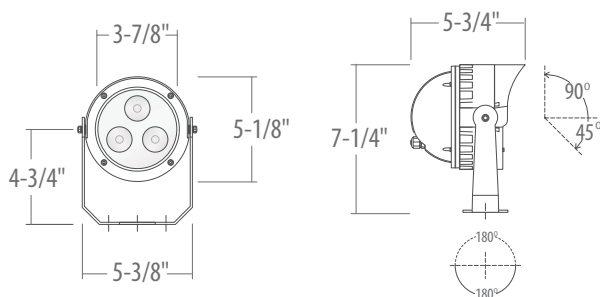

## ORDERING – Example: SS3-RGBW-3R-B60/SDE24V24RGBW-400

### HOUSING

**SS3-RGBW-3R**

### BEAM SPREAD

**Blank:** 25° Optic  
**-B60:** 60° Optic  
**-B90:** 90° Optic

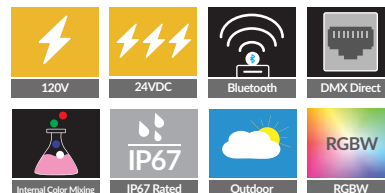

## ACCESSORIES

96W 120V/277V Power Supply with Junction Box LD533V024-1277-96-JB

- 120V-277V Input
- Electrical Junction Box Included
- Each power supply energizes up to 2 lights.



4 Channel 200W DMX Data Enabler

SDE24V24RGBW-400

- 12V or 24 DC Input
- cETLus listed
- DmX-512 (1990) & Pre-Programmed Control



## SPECIFICATIONS

### OUTPUT

Beam Angle: 25°, 60°

Lumens: 481 Max. Lumen

Efficacy (lm/W): 32 lm/W

LED Channels: Red/Green/Blue/White

### ELECTRICAL

Input Voltage: Direct 120~240 VAC input comes standard. 50/60 Hz

Power Consumption: 15W

### CONTROL

Interface: DMX direct via data enabler

Control System: DirectDMX Color Control. Color controlled with USITT DMX512A Standard Protocol to work with Coloronix or 3rd Party DMX Systems.

LED Die Colors: Red (620-635nm), Green (520-535nm), Blue (450-465nm) and Neutral White (5000k)

Static Color Available: All Standard Colors, Consult Factory.

Dimming: Smooth and flicker-free dimming of all colors down to 1% using Patented Color Mixing and Dimming technologies developed at Philips Color Kinetics®

Wireless Bluetooth Control: Bluetooth control via wireless. Call up standard colors or shows. One Bluetooth enabler per zone.

Color Mixing: Using InternaMix™ proprietary technology, colors are efficiently blended together through an internal mixing chamber. The one-color output reduces unsightly views of isolated Red, Green and Blue Diodes for a seamless rainbow-free appearance.

### LUMEN MAINTENANCE

L70 Life: 50,000 Hours for ambient temperatures under 95°F.

### PHYSICAL

Dimensions (Height x Width x Length): 7-1/4" x 5-3/4" x 5-3/8"

Housing Material: Made of die-cast aluminum to protect light emitting diodes, other electronics and preserve optical alignment. Steel screws installed on face plate for a tight gap-free installation onto housing. Cast aluminum tighttenging allows for 90° Tilt and 360° Rotation.

Weight: 4.2lbs.

Lens: Tempered glass

Connections: Standard power wiring to power supply, RJ45 data connections in/out on data enabler.

Mounting: Comes with mounting bracket for easy field adjustment

Temperature Range: -4°F - 113°F Ambient

### CERTIFICATION

Complies to UL1598 and ANSI/UL 8750. IP67 Rated

### WARRANTY

3-Year Warranty

## PHOTOMETRY

### FOOTCANDLE CALCULATION: SS3-RGBW-3R

HEIGHT	FC	BEAM SPREAD
10'	39	47"
15'	16	56"

### FOOTCANDLE CALCULATION: SS3-RGBW-3R-B60

HEIGHT	FC	BEAM SPREAD
10'	3.6	57"
15'	1.8	66"